

Street Naming & Numbering Record Record Number 20-24

<u>Original Designation/ Development Name</u>	<u>New Postal Address</u>	<u>Postcode</u>
LAND REAR OF 26-28 PORTFIELD ROAD CHRISTCHURCH BH23 2AG	1 AND 2 PORTFIELD GARDENS CHRISTCHURCH	TBC

PLAN

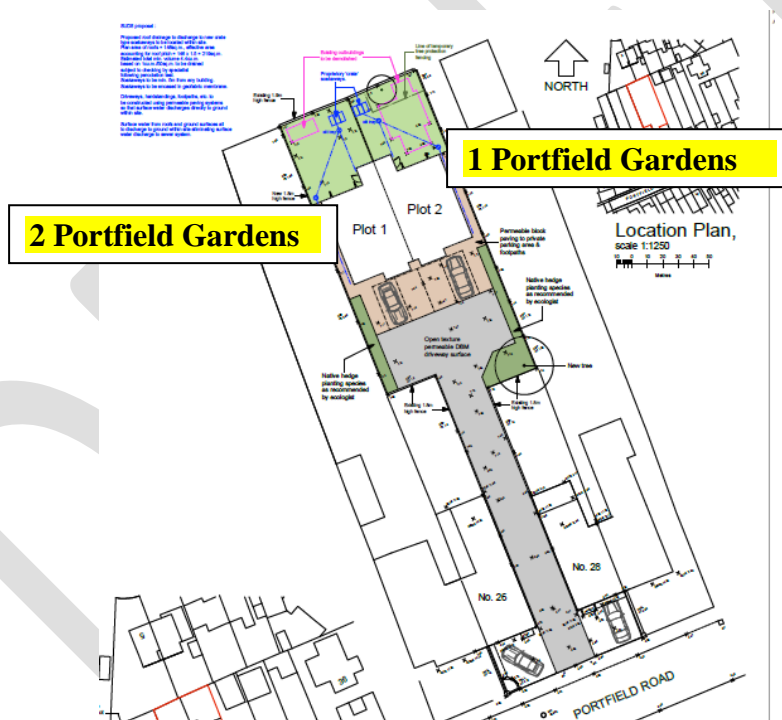

Please note;

The Council does not give any guarantee as to the accuracy of the details relating to the postcode quoted in this notice, and excludes all liability for any reliance placed on the postcode details shown. All persons should seek confirmation of details from the Royal Mail, or other appropriate body.

The allocation of postal addresses does not serve as confirmation that any building or structure has been authorised under Planning, Building Regulations or any other Legislation. Owners/occupiers may be at risk of enforcement action if any necessary approvals have not been obtained.